

1

2

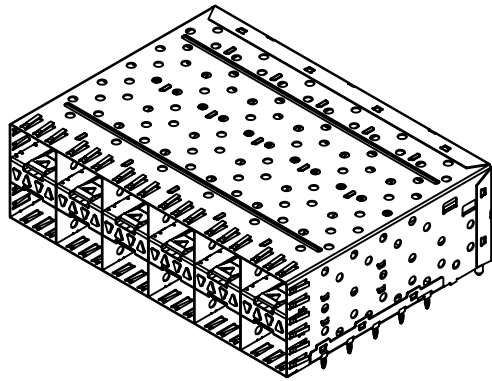

(4 LIGHT PIPE)

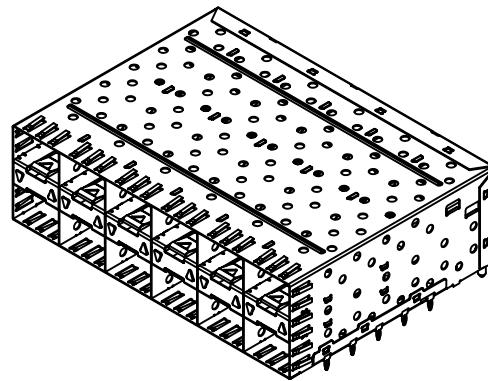

(2 OUTER LIGHT PIPE)

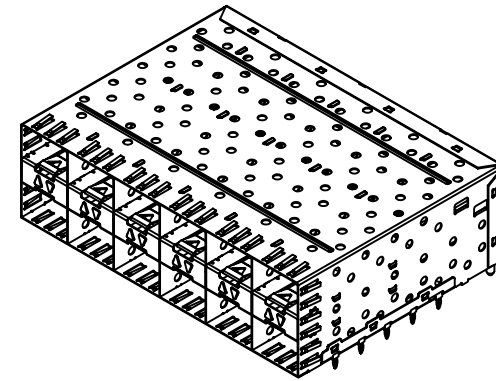

(2 INNER LIGHT PIPE)

NOTES:

MATERIAL:
CAGE: NICKEL SILVER

CONNECTOR:
PLASTIC HOUSING: HIGH TEMPERATURE LCP, UL94 V-0.
LIGHT PIPE: POLYCARBONATE; COLOR: CLEAR
SPRING: STAINLESS STEEL
CONTACTS: PHOSPHOR BRONZE
CONTACT PLATING: 15u" MIN. GOLD ON MATING AREA,
150u" MATTE TIN ON SOLDER TAILS
PACKAGING: TRAY PACKAGING.
TEMPERATURE RANGE: -40 C TO +85 C

GROUNDING PIN

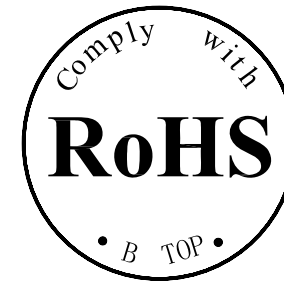
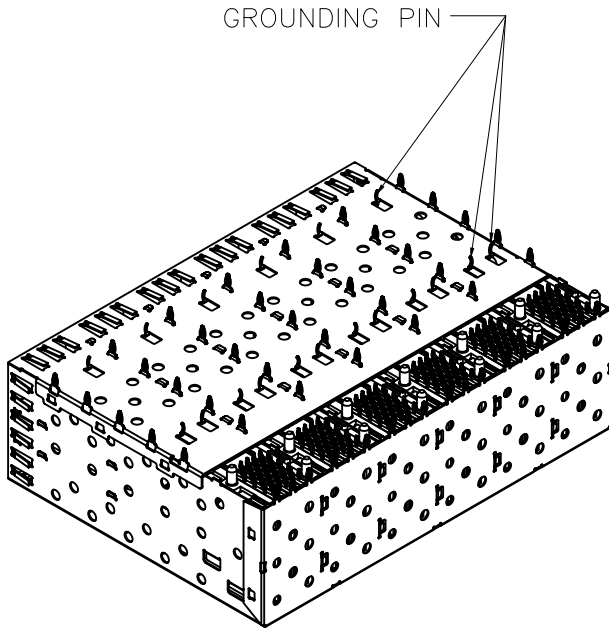

B N (Z) G X - M - A B C D - E H I

"B" with the company code

Series of products: 60: Double deck RJ45 connector + transformer series (in side long footprint); 59: Double deck RJ45 connector + transformer series (in vertical footprint); 58: Single RJ45 + transformer series; 52/53/55/56 LED/56/57/59: Ordinary RJ45 series; D: that strip line series; 40: Conversion said Connectivity 80: Series that UK; 91: Automotive connector public Block; 92: Automotive connector mother Block; 90: HDMI the head; 94: HDMI mother Block; 95: SMT series; 96: BMS for switches

Family code (sequence id): 1-99

Type of product code: G: Gigabit RJ45 transformer; F: 10Base RJ45 transformer; V: 100M transformer; R: RJ45 products; K: Series for board forward code

Number of magnetic ring
The No. of circuit

Product definition LOGO: 1 - Press "B-TOP"; 2 - No "B-TOP"; 3 - Other companies LOGO

Product definition plastic materials: 1-PA66, 2-PA46, 3-PA, 4-PA6, 5-PBT, 6-ABS, 7-PAST, 8-PC, 9-LCP

Pin definition of the product: F-Pin after; B-Pin back; C- No definition of the product

Electroplating product definition: gold-plated terminals (degrees after nickel plated) 1-F μ ; 2-3 μ ; 3-6 μ ; 4-15 μ ; 5-30 μ ; 6-50 μ ; 7-(NF-50 μ ; Sn-80-120 μ) ;

Product shielding definition: 0 - no shielding shell; 1 - without shielding shell strapnet; 2 - shielding a shell strapnet; 3 - a half-shield shell;

Products luminous definition: 0 - No LED; 1 - Left Yellow Right Green; 2 - Left Green Right Yellow; 3 - Double Green; 4 - Double Yellow; 5 - LED straight for the pin; 6 - A special definition; 7 - Single

Linear LED:

Products size code: 1-201 2-202 3-204 4-205 5-206 6-207 7-208 8-209 9-210 10-211 11-212 12-213 13-214 14-215 15-216 16-217 17-218 18-219 19-220 20-221 21-222 22-223 23-224 24-225 25-226 26-227 27-228 28-229 29-230 30-231 31-232 32-233 33-234 34-235 35-236 36-237 37-238 38-239 39-240 40-241 41-242 42-243 43-244 44-245 45-246 46-247 47-248 48-249 49-250 50-251 51-252 52-253 53-254 54-255 55-256 56-257 57-258 58-259 59-260 60-261 61-262 62-263 63-264 64-265 65-266 66-267 67-268 68-269 69-270 70-271 71-272 72-273 73-274 74-275 75-276 76-277 77-278 78-279 79-280 80-281 81-282 82-283 83-284 84-285 85-286 86-287 87-288 88-289 89-290 90-291 91-292 92-293 93-294 94-295 95-296 96-297 97-298 98-299 99-300

B-TOP® 东莞市博腾电子科技有限公司
Dongguan BroadTop Electronic Technology Co., Ltd.

Designed

Checked

Approved

MATERIAL

SCALE

1:1

UNIT

mm

DESCRIPTION

BSFP(16-02)S-6024-C92(SFP 2X6 EMI)

MODEL NO.

4-1

REV.

1.1

FIRST ANGLE PROJECTION

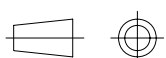

TEL: 0769-38926198
FAX: 0769-38926199
Website: www.BtopTech.cn
www.BtopTech.com

20170818

1

2

由 Autodesk 教育版产品制作

由 Autodesk 教育版产品制作

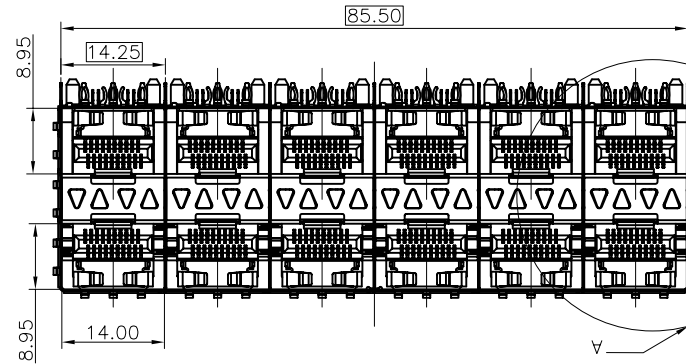
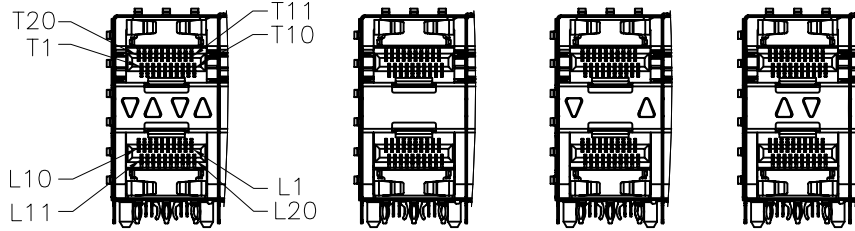
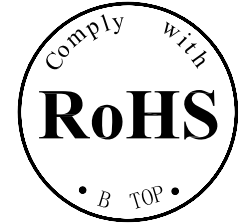
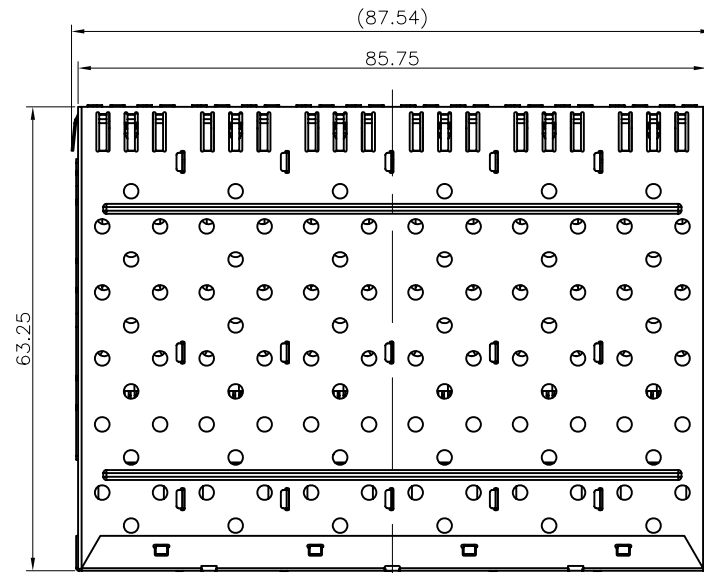
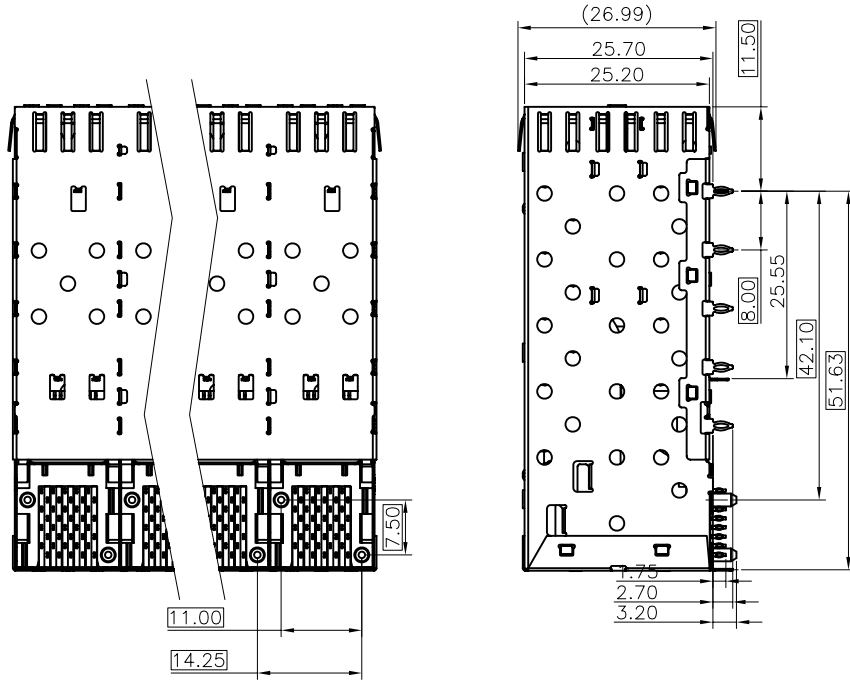

B-TOP® 东莞市博腾电子科技有限公司
Dongguan BroadTop Electronic Technology Co., Ltd.

Designed

MATERIAL

DESCRIPTION

BSFP(16-02)S-6024-C92(SFP 2X6 EMI)

Checked

SCALE

1:1

UNIT

mm

MODEL NO.

4-2

REV.

1.1

FIRST ANGLE
PROJECTION

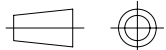

TEL: 0769-38926198
FAX: 0769-38926199
Website: www.BtopTech.cn
www.BtopTech.com

Approved

A

A

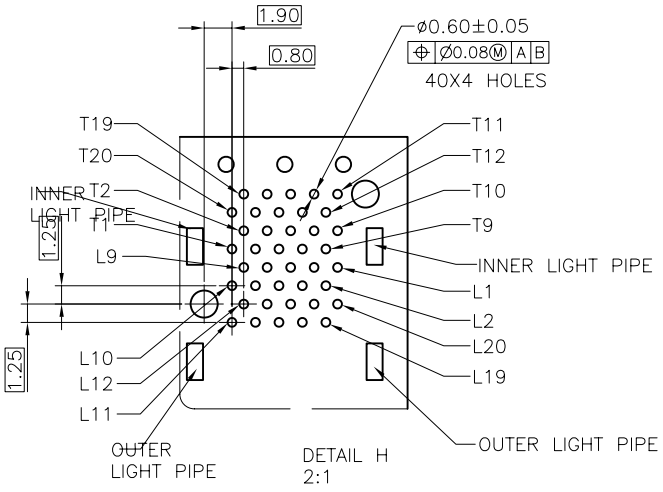
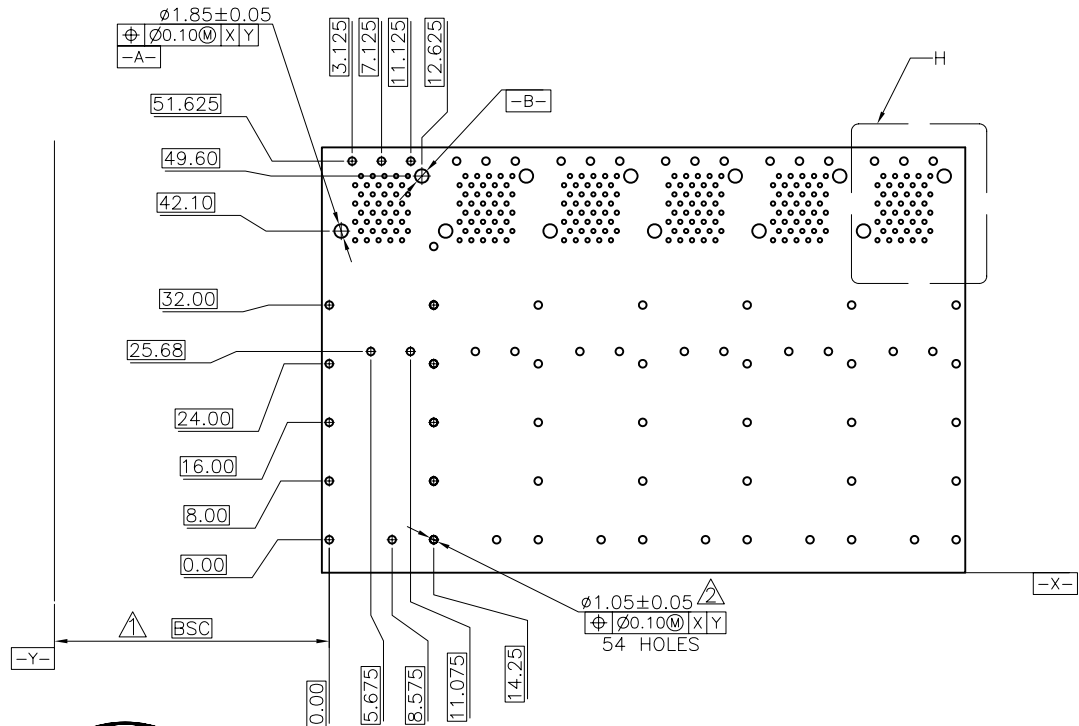

ECOMMENDED PCB CONFIGURATION

NOTES:

- DATUM AND BASIC DIMENSIONS ESTABLISHED BY CUSTOMER.
- 1.05 mm DIAMETER HOLES ARE CHASSIS GROUND (18 HOLES).

B-TOP® 东莞市博腾电子科技有限公司
Dongguan BroadTop Electronic Technology Co., Ltd.

Designed	MATERIAL		DESCRIPTION		BSFP(16-02)S-6024-C92(SFP 2X6 EMI)
Checked	SCALE	1:1	UNIT	mm	
Approved	MODEL NO.	4-3		REV.	
					1.1

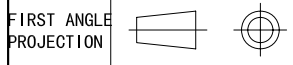

TEL: 0769-38926198
FAX: 0769-38926199
Website: www.BtopTech.cn
www.BtopTech.com

由 Autodesk 教育版产品制作

由 Autodesk 教育版产品制作

B

B

A

A

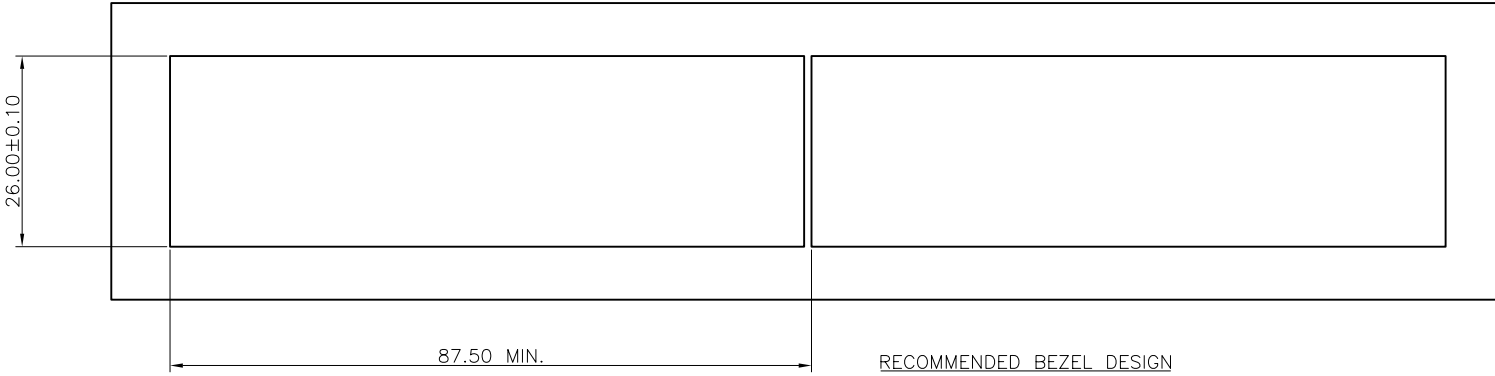

RECOMMENDED BEZEL DESIGN

由 Autodesk 教育版产品制作

由 Autodesk 教育版产品制作

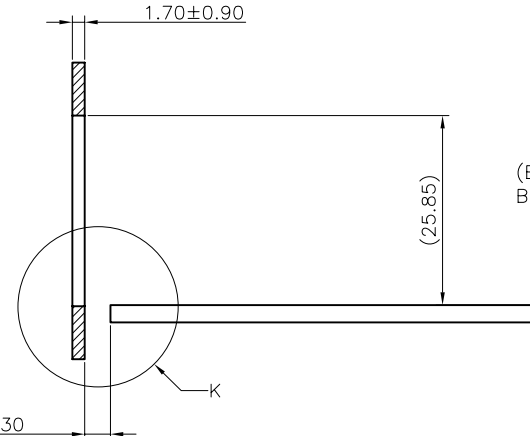
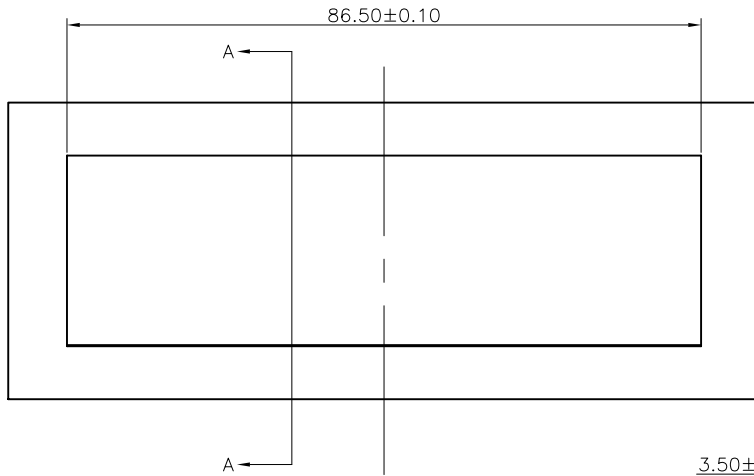

SECTION A-A

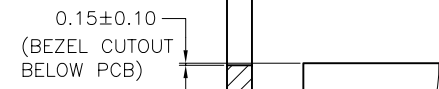

DETAIL K
2:1

B

B

B-TOP® 东莞市博腾电子科技有限公司
Dongguan BroadTop Electronic Technology Co., Ltd.

Designed	MATERIAL		DESCRIPTION		BSFP(16-02)S-6024-C92(SFP 2X6 EMI)
Checked	SCALE	1:1	UNIT	mm	
Approved	MODEL NO.		4-4		
					REV.
					1.1

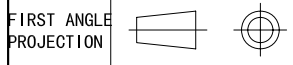

TEL: 0769-38926198
FAX: 0769-38926199
Website: www.BtopTech.cn
www.BtopTech.com